



Spedal NaviCam User Manual

Multifunctional Smart Motorcycle CarPlay Screen

CL876

033C3807-EN

1. Safety Guidelines

1.1 Warnings

- Do not operate this product while driving.
- Do not install or operate this product with wet hands.
- Do not install this product in a place with high temperature, humidity, flammable, explosive gas or liquid.
- Do not install this product in an area that interferes with the driver's sight or driving safety.
- Do not install this product on the airbag cover or within the working range of the airbag.
- Do not leave this product in a closed vehicle with high temperature for a long time.
- Do not operate this product over rated voltage.
- Do not use non-original cables and accessories.
- Do not use sharp objects such as awls or scissors to cut this product and its accessories.
- Do not disassemble, repair or modify this product and accessories by yourself.
- Do not install, use or place this product within the reach of children under 16 years of age.

1.2 Precautions

- Do not press the lens too hard to avoid damage or dislocation of the lens.
- Do not directly touch the lens surface, so as not to affect the recording effect.
- Do not remove the memory card during the shutdown process to avoid file damage.
- When using the memory card for the first time, please format it on this product to ensure stable reading and writing.
- When not using the product for a long time, please pull out the memory card to ensure the performance of the memory card.

Scan the QR code, select the corresponding model, and view the User Manual.

<https://spedal.cc/html/support/download/navicam.html>

For any questions please contact support@spedaltech.com



2. User Manual

2.1 Packing List

◆ Device



◆ Mount bracket



◆ Screws



◆ Wrench



◆ Manual screw



◆ Power cable



◆ Bottom cover plate



◆ Quick guide



◆ Camera x2
(Optional)

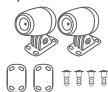

◆ Camera extension
cable(Optional)



◆ TF Card(Optional)



◆ Tire pressure
sensor x2(Optional)



◆ Wired remote
(Optional)



◆ Anti-slip pad
(Optional)

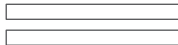

Note

Do not use cables and components that are not original. Gifts and accessories are not covered under warranty. The package contents of this product may change without prior notice, and the actual contents of the package shall prevail.

2.2 Product Illustration

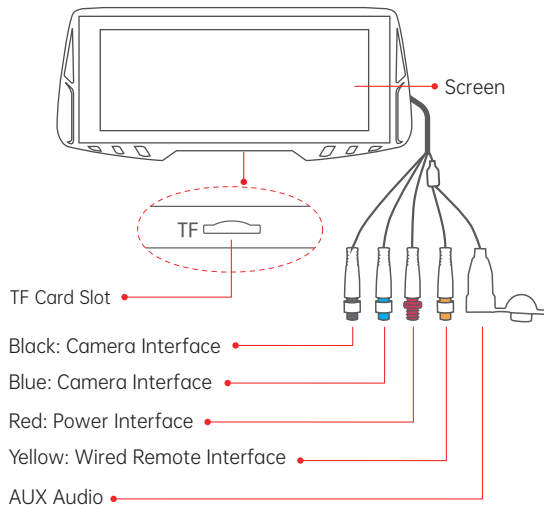

2.3 Bracket Installation

1. Align the universal bracket's screw hole with the hole on the back of the device, use a wrench to tighten the screw into the hole.
2. Insert the bracket into the motorcycle crossbar and tighten the screws.
3. Adjust the device screen to the appropriate angle, and then tighten the screws (as indicated by the arrow in the figure below).

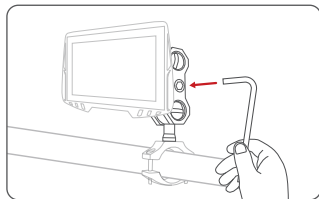
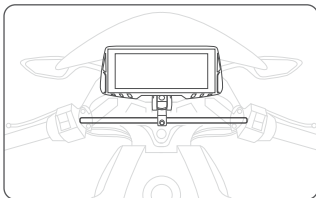
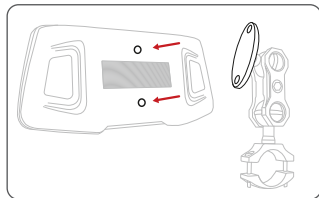

Note

The installation position of equipment and brackets should not block the driver's sight and affect driving safety.

2.4 Device Installation

1. Connect the power cord from the package to the power take-off interface of the motorcycle (be careful not to reverse the polarity).



Red wire: Connected to the ACC power (only powered when the ignition switch is on).

Black wire: Connected to the ground line.

Yellow wire: Connected to the constant power supply from the power box.

2. Insert the other end of the power cord into the power port of the device.

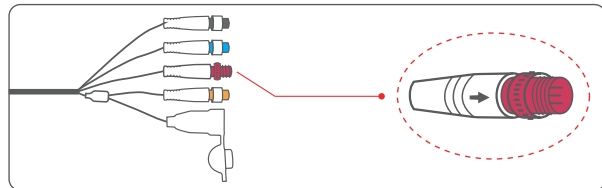

2.5 Wired Remote Installation

1. Use a screwdriver to unscrew the screws on the remote and open the fixing ring.
2. Attach the remote's fixing ring to the motorcycle handlebar and tighten the screw.
3. Adjust the remote to a convenient operation angle, tighten the screw to prevent loosening.
4. Connect the remote to the device (the remote connects with the device's green port), and the installation is complete.

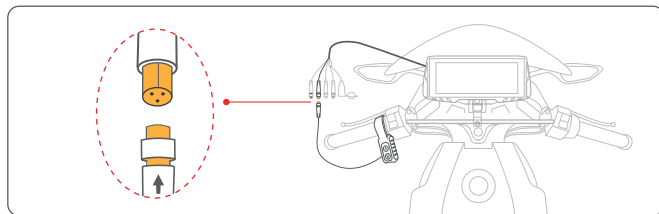
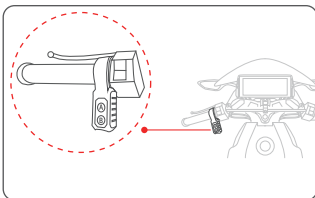
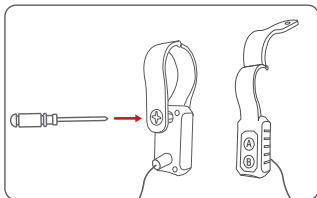

Button A

Short press: One-click photo
Long press for 10 seconds: Forced shutdown (short press again to turn on)
Short press during an incoming call: Answer the call

Button B

Short press: Toggle between the main page, phone interconnection interface, and recording interface
Long press for 5 seconds: Turn off/on touch function
Short press during an incoming call: Hang up the call

2.6 Audio Cable Installation

1. Insert the audio cable into the AUX port of the speaker, then connect the other end to the AUX port of the device.
2. Switch the audio output to AUX on the device.

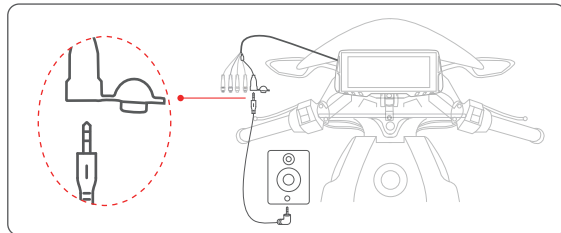

2.7 Camera Installation

1. Use the screws in the package to respectively fix the front and rear cameras to the front and rear of the motorcycle (as shown in the figure below).
2. Connect the front and rear cameras to the device respectively (as shown in the figure below).
3. Adjust the camera to an appropriate angle to complete the installation.

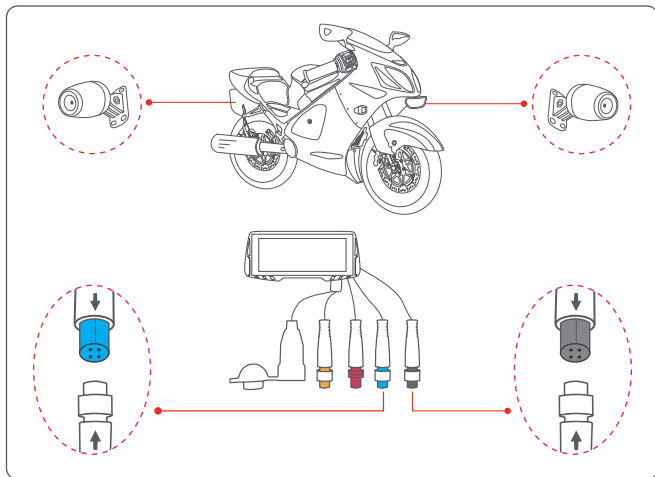

2.8 Tire pressure sensor Installation

1. Inflate the tires to the appropriate tire pressure, align the tire pressure sensor with the tire valve stem, and tighten it using a wrench.
2. Click on the motorcycle icon on the left side of the device screen to enter the tire pressure settings menu and bind the tire pressure sensor.

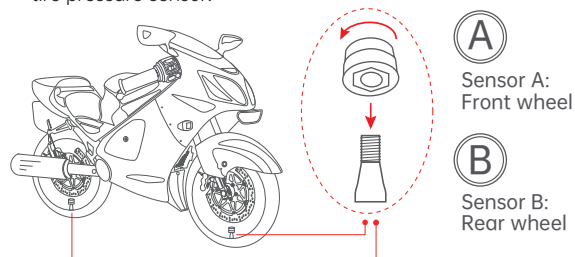

2.9 TF Card Installation

1. Remove the bottom cover of the device and insert the TF card into the TF card slot.
2. The self-provided TF card should meet the following conditions:
 - a. Read and write speed is Class 10 or above.
 - b. Supports up to 256GB.

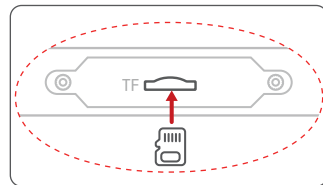



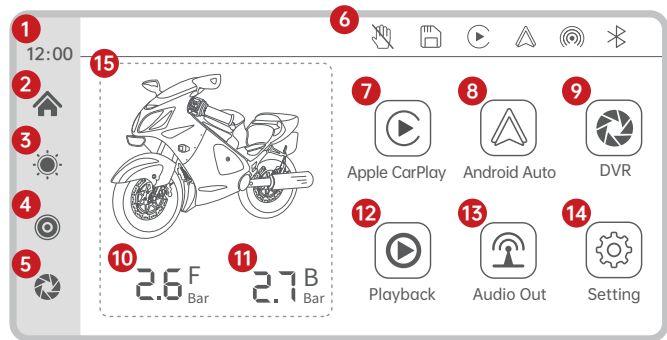

3. Features and Settings

3.1 Home Screen



- 1 12:00 System time
- 2 Homepage
- 3 Adjust Screen
- 4 Adjust AUX Audio Output Volume

- 5 Enter DVR Mode
- 6 Touch Function Turned Off (can be turned on via wired remote)
- TF Card Inserted
- Apple CarPlay Connected
- Android Auto Connected
- Bluetooth Status
Blue : Connected
- 7 Apple CarPlay Mode
- 8 Android Auto Mode
- 9 DVR Mode
- 10 F Bar
Front Tire Pressure

- 11  Rear Tire Pressure
- 12  Video Playback Mode
- 13  Audio Output
- 14  Settings
- 15 Binding Tire Pressure Monitoring Sensor, as well as setting of tire pressure alarm and tire pressure unit.

3.2 Apple CarPlay

3.2.1 Apple CarPlay wireless connection

Note

Requirements for phone versions that support wireless CarPlay: iPhone running iOS 9 or later. (For example, iPhone XR and later, iPhone 11 and later, iPhone SE (second generation) and later, etc.) Both CarPlay in-car and iPhone voice system need to be turned on, please check if Siri is enabled; For the first time connecting to wireless CarPlay, the connection time is about 30 seconds, please be patient. For more detailed information, please visit: <http://www.apple.com/ios/carplay>

If you need to display Apple CarPlay in split-screen mode, click the "Half Screen mode" button before connecting Apple CarPlay to enter split-screen display mode.

(If you need to switch to full-screen display mode, disconnect CarPlay, then enter the Apple CarPlay interface and click the "Full screen mode" button.)

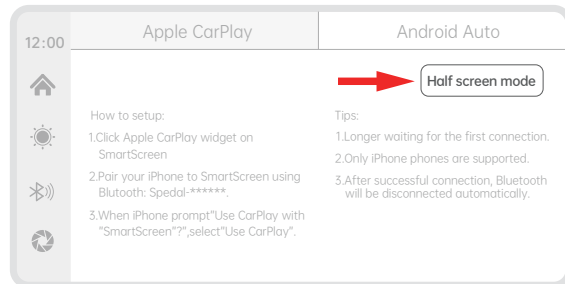

1. Enter the Settings menu on your iPhone, and turn on Bluetooth and Wi-Fi.
2. Go to the Bluetooth menu, and under the 'Other DEVICES' list, select the Bluetooth name 'Spedal-*****'.
3. Wait for about 20-30 seconds, a 'Bluetooth Pairing Request' pop-up will appear on your phone. Choose 'Pair', and the pairing between your phone and the device will be successful.
4. Then, a pop-up will appear on your phone asking, 'Use CarPlay with "SmartScreen"?'. Select 'Use CarPlay'.
5. Please wait for a moment, you will enter CarPlay mode shortly.

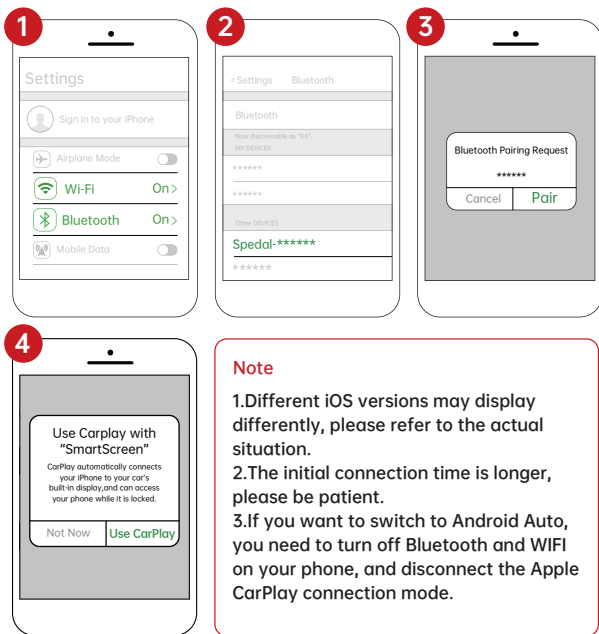

Note

1. Different iOS versions may display differently, please refer to the actual situation.
2. The initial connection time is longer, please be patient.
3. If you want to switch to Android Auto, you need to turn off Bluetooth and WIFI on your phone, and disconnect the Apple CarPlay connection mode.

3.2.2 Apple CarPlay Audio Output

Click on "🔊" on the main screen to enter the audio output mode.

1. Bluetooth

🔊 Sound is played through a Bluetooth headset via a Bluetooth connection.

- (1) First turn on the Bluetooth headset to make it searchable.
- (2) Click on "🔄" on the device's audio output page and wait for the Bluetooth headset to be searched.
- (3) Wait a moment, and the name of the Bluetooth headset will be displayed in the "Bluetooth Headset" list.
- (4) Click on the name of the Bluetooth headset, and after the prompt box pops up, click "Connect" and wait for the device to pair with the Bluetooth headset.
- (5) After the pairing is complete, "Connected" is displayed next to the name of the Bluetooth headset. The connection is complete and the sound is played through the Bluetooth headset.

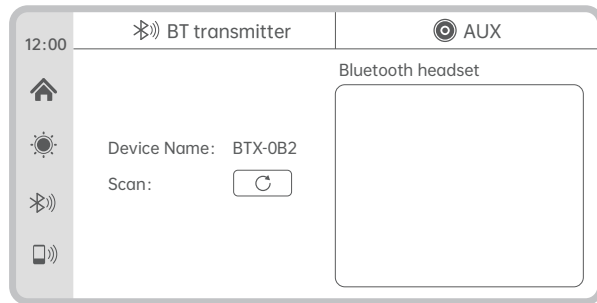

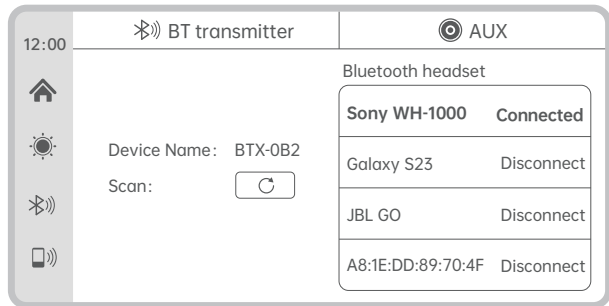

2. AUX Connection

 Connected via AUX cable to the speaker, sound is played from the speaker.

2.1 Plug one end of the AUX cable into the device's AUX port, and then connect the other end to the speaker's AUX port.

2.2 Switch audio output to AUX.

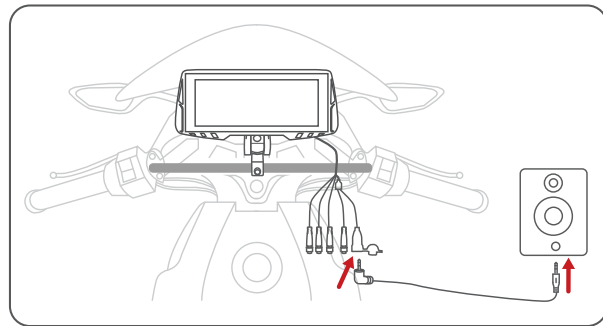

3.3 Android Auto

3.3.1 Android Auto Wireless Connection

Note

1.Requirements for smartphones that support wireless Android Auto:

Please make sure that the phone's system version is Android 5.0 or above, or update the phone's system version to the latest. The first connection time takes about 20 seconds, please be patient.

2. Phones running Android 11 or higher. (For example, Google Pixel 3 and above; Samsung Galaxy S8 and above; OnePlus 8 and above; LG V40 and above, etc.)
3. Phones that support 5GHz Wi-Fi.
4. Phones with Google Play services.

1. Enter the Settings menu on your phone and turn on Wi-Fi and Bluetooth.
2. Click on "Bluetooth" to enter the Bluetooth search page.
3. After entering the Bluetooth menu, click on "Pair new devices" to find new Bluetooth devices.
4. In the list of discovered Bluetooth devices, select the one that begins with "Spedal-*****" to pair.
5. Wait approximately 20 seconds, a dialog box pops up on the phone saying "Pair with Spedal- *****", click "Pair", wait a moment, once the Bluetooth pairing is complete, the Android Auto connection will be completed, and it will automatically enter Android Auto mode.

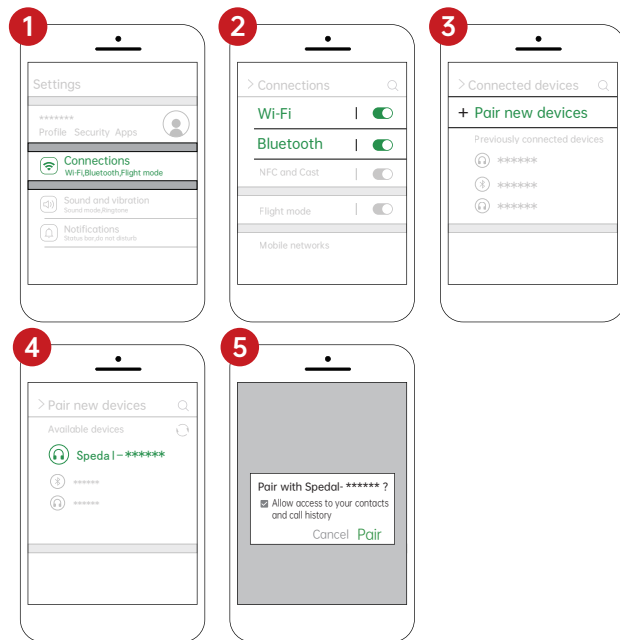

Note

1. Different Android phone models may display differently, please refer to the actual situation.
2. The initial connection time may be longer, please be patient.

3.If you want to switch to Apple CarPlay, you need to turn off Bluetooth and WIFI on your phone and disconnect the Android Auto connection mode.

3.3.2 Android Auto Audio out

1. Bluetooth

 The same as the page 08--3.2.2--1.Bluetooth.

2.AUX Connection





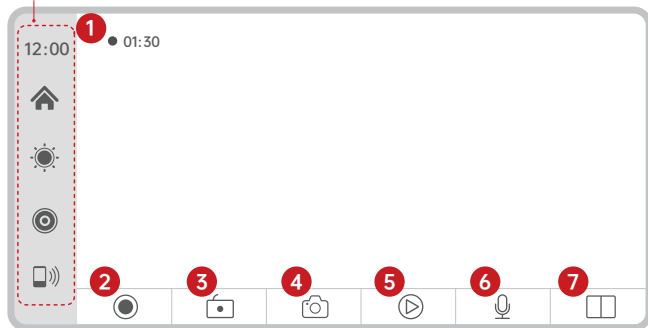

 The same as the page 09--3.2.2--2.Aux Connection.

3.4 DVR

Click on " " on the main screen to enter DVR mode.

Refer to [3.1 Home Screen]



- 1 ● 01:30 Video Duration
- 2 ☒ Start Recording ☐ Stop Recording
- 3  Unlock Current Recording
 Lock Current Recording
- 4  Take Photo on Current Screen
- 5  Video Playback
- 6  Recording with sound  Recording without sound
- 7  Front and Rear Camera Display



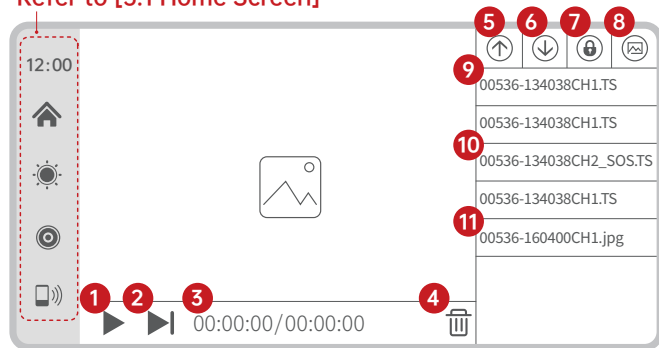

3.5 Playback

Click on the "  " on the main screen to enter Playback Mode, where you can play, lock, unlock, and delete videos or pictures.

Refer to [3.1 Home Screen]



- 1  Play video
- 2  Play next video

- 3 00:00:00/00:00:00
Playback progress / Video duration
- 4  Delete current video
- 5  Sort video list from nearest to farthest
- 6  Sort video list from farthest to nearest
- 7  View locked video files
- 8  View photos
- 9 Video files
- 10 Locked video files
- 11 Photos

3.6 Setting

Click on the " " on the main screen to enter the settings mode.



Video Resolution

Set the video resolution. It can be set to front and rear 720P+720P, 1080P+1080P, or 2K+2K.



Loop Recording

Set the recording time for each video. It can be set to 1 minute, 3 minutes, or 5 minutes. The system default is 3 minutes.



Screen Mirroring

Flip the recording screen left and right.



Screen Saver

Set the screen saver start time. It can be set to 10 seconds, 30 seconds, or 1 minute.



Language Settings

Set the language displayed by the system. It can be set to 简体中文, 繁體中文, English, Français, Español, Português, Deutsch, Italiano, Русский, 日本語 and 한국어.



Time Settings

Set the date and time, as well as the date format.



Format

Delete all data on the TF card. This operation is irreversible, so please backup videos and photos before performing this operation.



Factory Reset

Restore all settings to the factory default values.



Software Version

View the current software version information of the device.

3.7 Tire Pressure Monitoring Settings

Appuyez sur la moto ou la zone d'affichage de la pression des pneus à gauche de l'écran principal pour associer les capteurs de pression des pneus et configurer les paramètres liés à la surveillance de la pression des pneus.

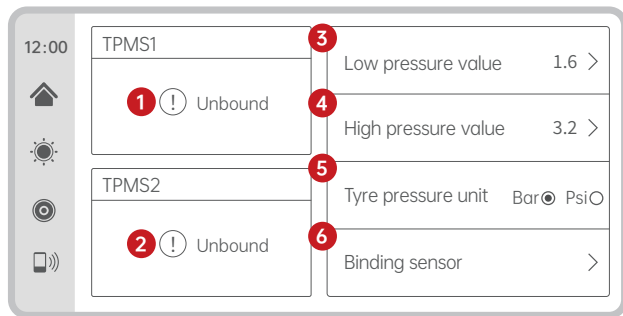

- 1 Afficher la pression des pneus avant

- 2 Afficher la pression des pneus arrière
- 3 Définir la valeur d'alerte basse. Une notification apparaîtra lorsque la pression est inférieure à la valeur définie.
- 4 Définir la valeur d'alerte élevée. Une notification apparaîtra lorsque la pression est supérieure à la valeur définie.
- 5 Définir l'unité de pression des pneus, en bar ou en psi.
- 6 Associer les capteurs de pression des pneus, associer les capteurs avant, associer les capteurs arrière ou dissocier tous les capteurs.



more product information
www.spedal.cc



more product videos
youtube search [pedal](#)

- EN** Download manuals of other languages from our homepage.
- DE** Laden Sie Handbücher in anderen Sprachen von unserer Homepage herunter.
- FR** Téléchargez des manuels dans d'autres langues depuis notre page d'accueil.
- ES** Descargue manuales en otros idiomas desde nuestra página de inicio.
- IT** Scarica manuali in altre lingue dalla nostra homepage.

USA Customer Service Hotline: [+1\(463\)207-9998](tel:+14632079998)

For any questions please contact support@spedaltech.com